

February 2021

HS2

High Speed Rail (London – West Midlands)

**Bromford Tunnel Extension
Environmental Impact Assessment Screening Report
Map Book**

February 2021

HS2

High Speed Rail (London – West Midlands)

**Bromford Tunnel Extension
Environmental Impact Assessment Screening Report
Map Book**

High Speed Two (HS2) Limited,
Two Snowhill
Snow Hill Queensway
Birmingham B4 6GA

Telephone: 08081 434 434

General email enquiries: HS2enquiries@hs2.org.uk

Website: www.hs2.org.uk

High Speed Two (HS2) Limited has actively considered the needs of blind and partially sighted people in accessing this document. The text will be made available in full on the HS2 website. The text may be freely downloaded and translated by individuals or organisations for conversion into other accessible formats. If you have other needs in this regard, please contact High Speed Two (HS2) Limited.

© High Speed Two (HS2) Limited, 2021, except where otherwise stated.

Copyright in the typographical arrangement rests with High Speed Two (HS2) Limited.

This information is licensed under the Open Government Licence v3.0. To view this licence, visit www.nationalarchives.gov.uk/doc/open-government-licence/version/3  or write to the Information Policy Team, The National Archives, Kew, London TW9 4DU, or e-mail: psi@nationalarchives.gsi.gov.uk. Where we have identified any third-party copyright information you will need to obtain permission from the copyright holders concerned.



Structure of the High Speed Rail (London – West Midlands) Bromford Tunnel Extension Environmental Impact Assessment Screening Report

This document is part of the suite of documents that make up the Bromford Tunnel Extension Environmental Impact Assessment (EIA) Screening Report, as described below:

- Executive Summary. This provides a summary, in non-technical language, of the report findings.
- Screening Report. This introduces the report, provides a description of Bromford Tunnel Extension and an overview of the area in which it is located, and sets out the corresponding EIA screening assessment.
- Appendices. These contain supporting environmental information.
- Map Book. This contains supporting maps, including a plan sufficient to identify the land relating to Bromford Tunnel Extension (Site Location Plan), and plans showing the Bromford Tunnel Extension proposals.

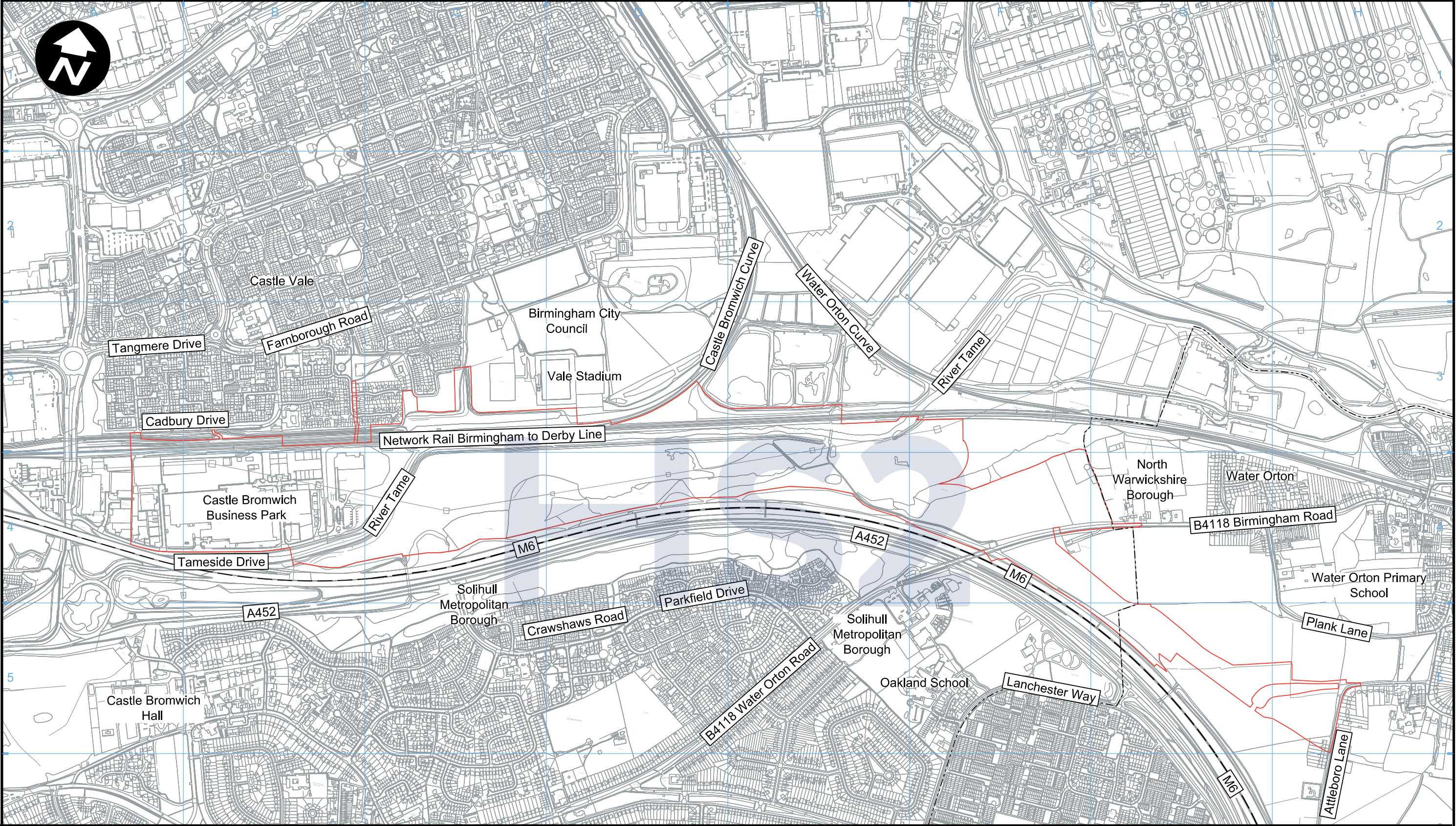

Legend:	
	County boundary
	Site Boundary
	Borough / District boundary

Fit for Stage Acceptance

P02.1	S4 Issue	--	--	--	--	HS2 accepts no responsibility for any circumstances which arise from the reproduction of this document after alteration, amendment or abbreviation or if it is issued in part or issued incompletely in any way.
P01	S4 Issue	RAVI	MCAR	MSHE	--	© Crown Copyright and database right 2018. All rights reserved. Ordnance Survey Licence number 100049190. © Crown Copyright material is reproduced with the permission of Land Registry under delegated authority from the Controller of HMSO. This material was last updated on 2018 and may not be copied, distributed, sold or published without the formal permission of Land Registry. Only an official copy of a title plan or register obtained from the Land Registry may be used for legal or other official purposes.
Rev	Description	Drawn	Checked	Approved	Con App	Scale with caution as distortion can occur.

- Legends/Notes:
1. Do not scale from drawing.
 2. All dimensions are in millimeters unless otherwise specified.



HS2

Registered in England: Registration No. 06791686
Registered office: 2 Snow Hill, Queensway, Birmingham, B4 6QA

Official

Creator/Originator
Balfour Beatty VINCI

Project/Contract High Speed Rail (London-West Midlands) (Bromford Tunnel) Screening Report			
Zone Bromford Tunnel	Drawn --	Checked --	Approved --
Drawing Title Figure 2.1 Site Location Plan	Date --	Scale 1:10000	Size A3
	Deliverable Yes (MIDP)	Gate EDD-IDR	Suitability S4
Drawing No. 1MC08-BBV_MSD-EV-DSP-NS02_NL07-170601	Rev. P02.1		

This document is issued for the party which commissioned it and for specific purposes connected with the captioned project only. It should not be relied upon by any other party or used for any other purpose. We accept no responsibility for the consequences of this document being relied upon by any other party, or being used for any other purpose, or containing any error or omission which is due to an error or omission in data supplied to us by other parties.

© Copyright Controller HMSO 2018. This material is published for High Speed Two (HS2) Limited with the permission of the Controller of Her Majesty's Stationery Office. The authors of this information are employed by Balfour Beatty Vinci JV. The work reported herein was carried out under a deed placed on 01/08/2017 by High Speed Two (HS2) Limited and should not be relied upon as authoritative by any third party. This report shall not be copied or reproduced in whole or in part except with the express consent of High Speed Two (HS2) Limited.

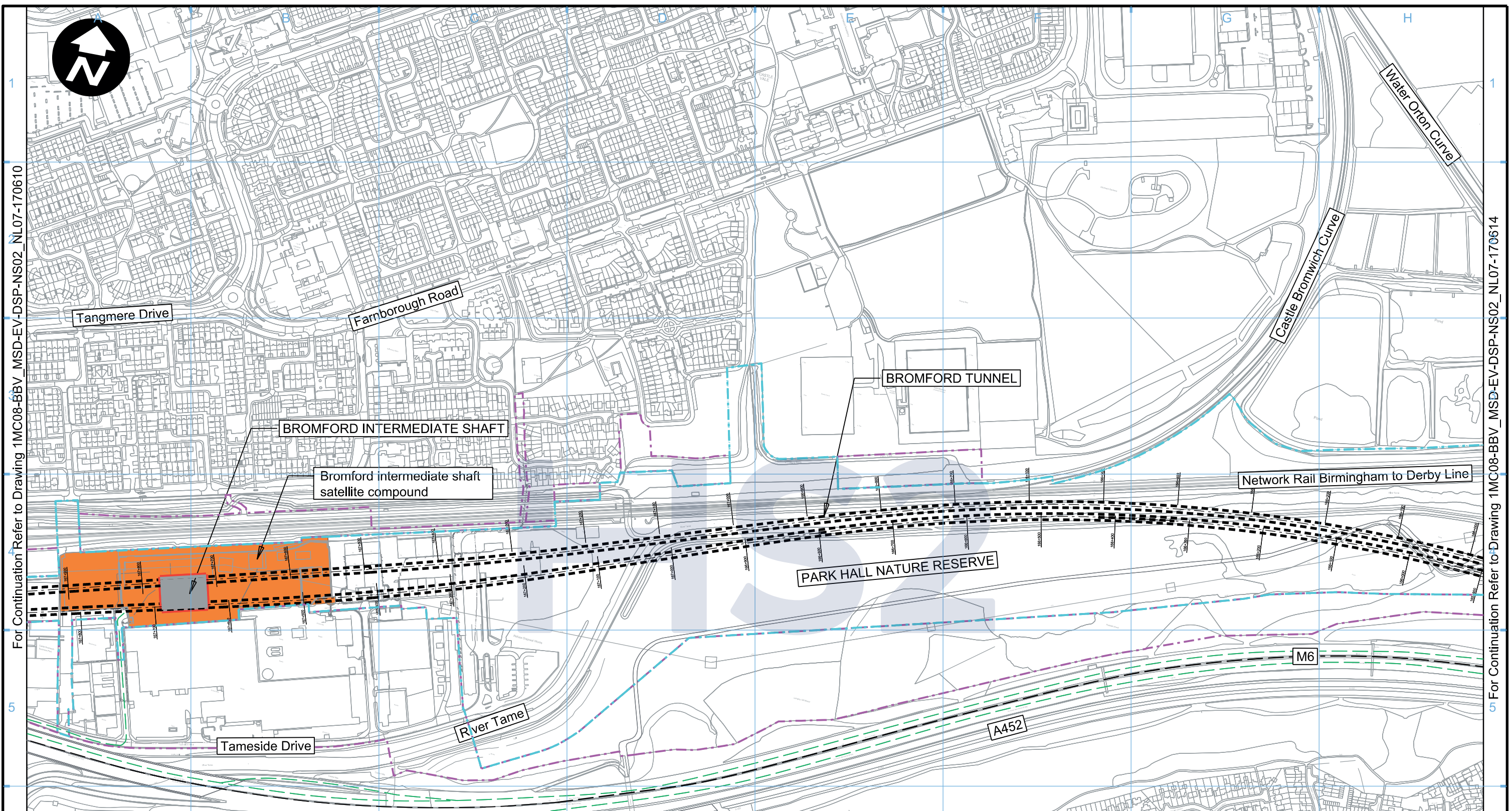

Note: Bridge Profiles indicated at FRL to HS2 track

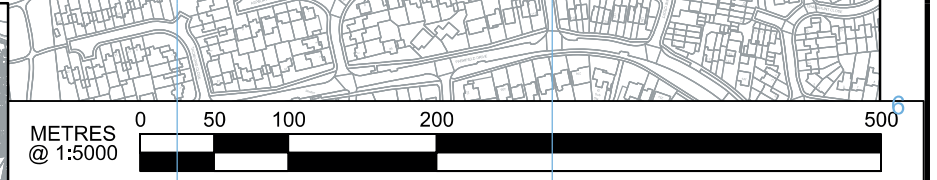
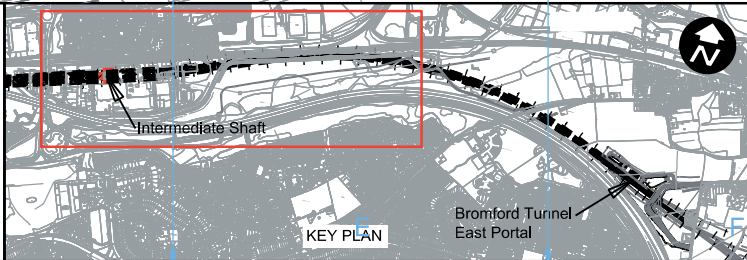

Fit for Stage Acceptance

P03.1	S4 Issue	--	--	--	--	HS2 accepts no responsibility for any circumstances which arise from the reproduction of this document after alteration, amendment or abbreviation or if it is issued in part or issued incompletely in any way.
P02	S4 Issue	RAVI	MCAR	MSHE	--	© Crown Copyright and database right 2018. All rights reserved. Ordnance Survey Licence number 100049190
P01	S3 Issue	RAVI	MPH	MSHE	--	© Crown Copyright material is reproduced with the permission of Land Registry under delegated authority from the Controller of HMSO. This material was last updated on 2018 and may not be copied, distributed, sold or published without the formal permission of Land Registry. Only an official copy of a title plan or register obtained from the Land Registry may be used for legal or other official purposes.
Rev	Description	Drawn	Checked	Approved	Con App	Scale with caution as distortion can occur.

Legends/Notes:

- Do not scale from drawing.
- All dimensions are in millimeters unless otherwise specified.

ROUTE WIDE KEY PLAN

HS2

Registered in England: Registration No. 08791688
Registered office: 2 Snow Hill, Queensway, Birmingham, B4 6QA

Official

Creator/Originator
Balfour Beatty VINCI

Project/Contract High Speed Rail (London-West Midlands) (Bromford Tunnel) Screening Report					
Zone	Bromford Tunnel		Drawn	Checked	Approved
Drawing Title	Figure 2.2 (Sheet 1) Proposed Development – Construction Phase		Date	Scale	Size
			Deliverable	Gate	Suitability
			Yes (MIDP)	EDD-IDR	S4
Drawing No.	1MC08-BBV_MSD-EV-DSP-NS02_NL07-170613		Rev.	P03.1	

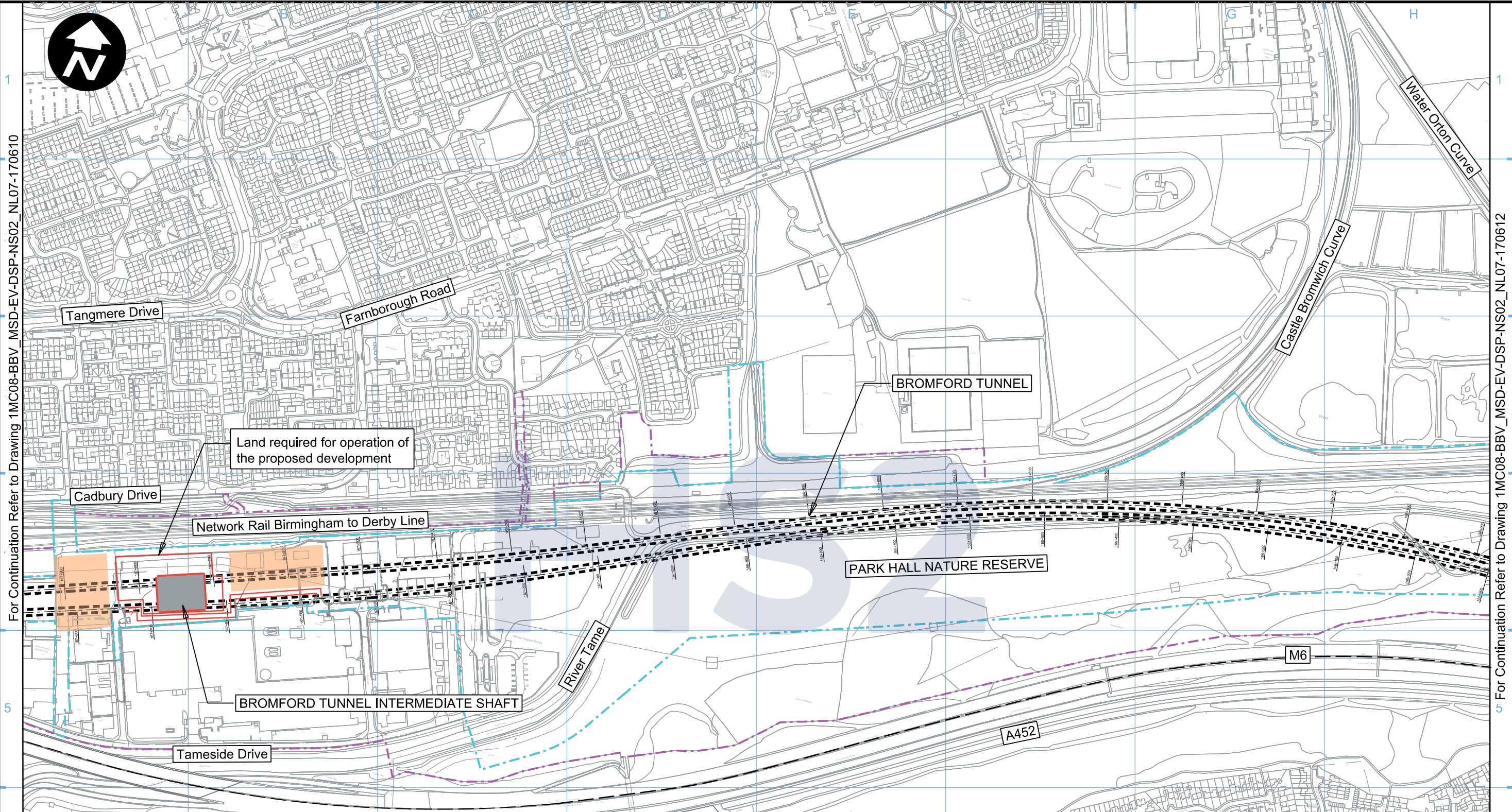

Note: Bridge Profiles indicated at FRL to HS2 track

Depot, station, headhouse or portal building	Landscape mitigation planting (scrub / woodland)	Returned to suitable development use
Tunnel portal	Grassed areas	County boundary
Electricity substation	Borough / District boundary	UT Main utility works
Balancing pond	Rail alignment formation	Tunnels external extent

--- Rail alignment
--- HS2 Access road
--- Chainage (e.g. 10+000)
--- LLAU - Limits of Land to be Acquired or Used 2017 Act (unchanged)
--- LOD - Limits of Deviation 2017 Act (unchanged)

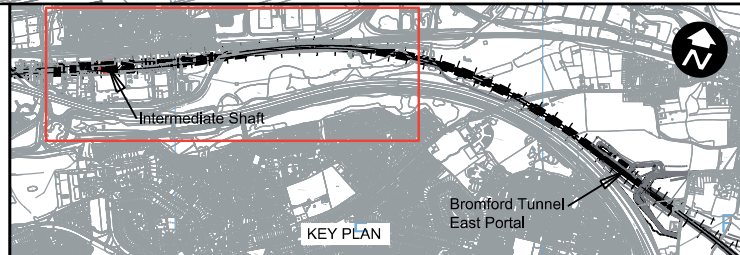

METRES @ 1:5000

0 50 100 200 500

Fit for Stage Acceptance

P03.1	S4 Issue	--	--	--	--	HS2 accepts no responsibility for any circumstances which arise from the reproduction of this document after alteration, amendment or abbreviation or if it is issued in part or issued incompletely in any way.
P02	S4 Issue	RAVI	MCAR	MSHE	--	© Crown Copyright and database right 2018. All rights reserved. Ordnance Survey Licence number 100049190
P01	S3 Issue	RAVI	MPH	MSHE	--	© Crown Copyright material is reproduced with the permission of Land Registry under delegated authority from the Controller of HMSO. This material was last updated on 2018 and may not be copied, distributed, sold or published without the formal permission of Land Registry. Only an official copy of a title plan or register obtained from the Land Registry may be used for legal or other official purposes.
Rev	Description	Drawn	Checked	Approved	Con App	Scale with caution as distortion can occur.

Legends/Notes:

- Do not scale from drawing.
- All dimensions are in millimeters unless otherwise specified.

ROUTE WIDE KEY PLAN

HS2

Registered in England: Registration No. 06791686
Registered office: 2 Snow Hill, Queensway, Birmingham, B4 6GA

Official

Creator/Originator
Balfour Beatty VINCI

Project/Contract	High Speed Rail (London-West Midlands) (Bromford Tunnel) Screening Report		
Zone	Bromford Tunnel		
Drawing Title	Figure 2.3 (Sheet 1) Proposed Development – Operational Phase		
Date	--	Scale	1:5000
Deliverable	Yes (MIDP)	Gate	EDD-IDR
Drawing No.	1MC08-BBV_MSD-EV-DSP-NS02_NL07-170611	Rev.	P03.1

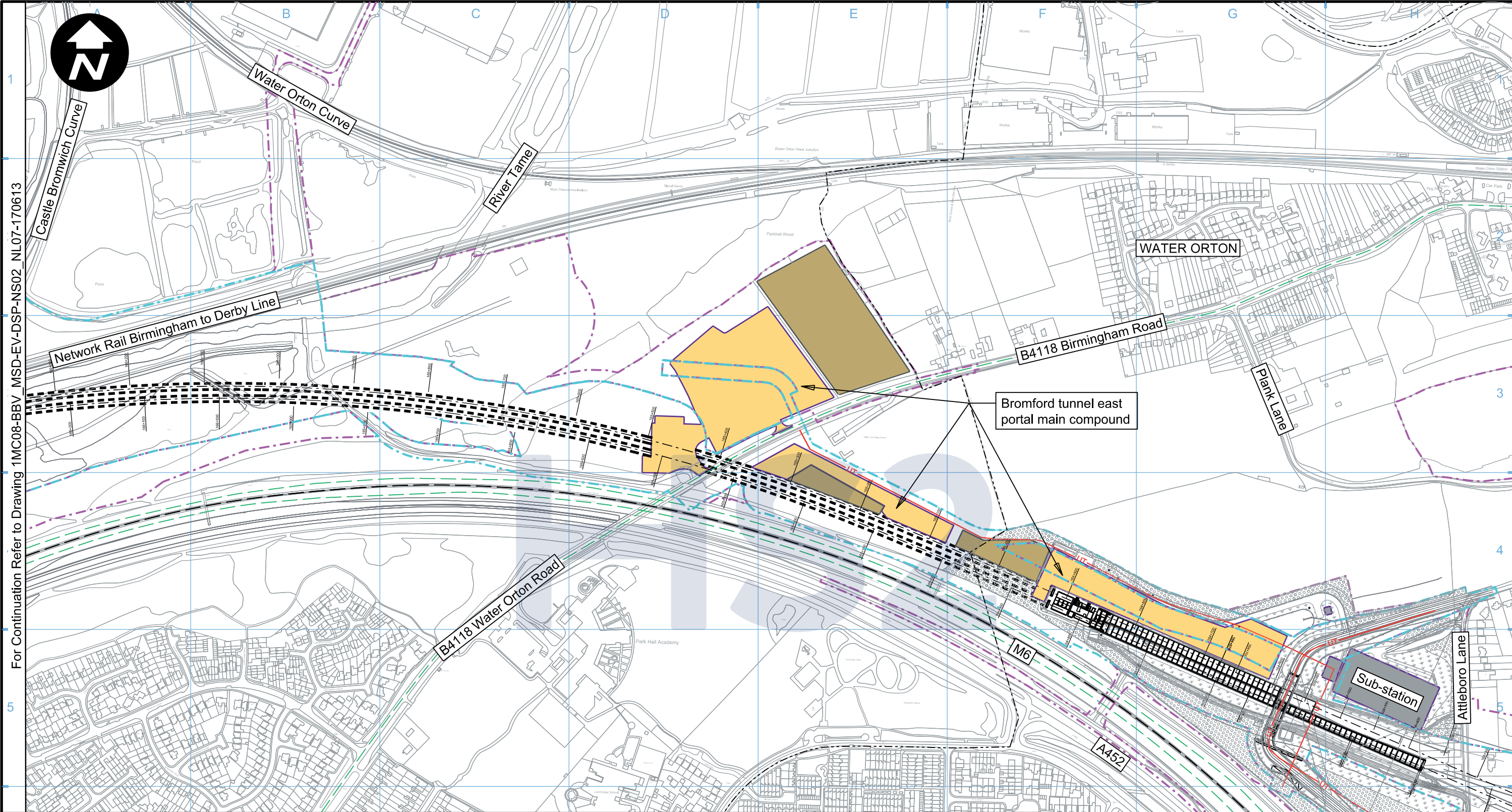

Note: Bridge Profiles indicated at FRL to HS2 track

- Depot, station, headhouse or portal building

Substation

Tunnel portal

Main construction compound

Satellite construction compound

Temporary material stockpile

Rail alignment formation

County boundary

Borough / District boundary

UT Main utility works

Tunnels external extent

Construction traffic route

Chainage (e.g. 10+000)

Rail alignment

LLAU - Limits of Land to be Acquired or Used 2017 Act (unchanged)

LOD - Limits of Deviation 2017 Act (unchanged)

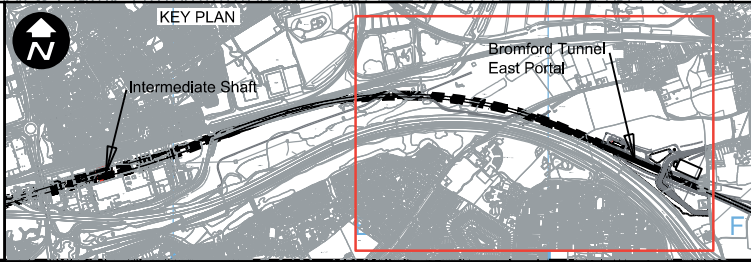

Fit for Stage Acceptance

P03.1	S4 Issue	--	--	--	--	HS2 accepts no responsibility for any circumstances which arise from the reproduction of this document after alteration, amendment or abbreviation or if it is issued in part or issued incompletely in any way.
P02	S4 Issue	RAVI 02/10/20	MCAR 02/10/20	MSHE 02/10/20	--	© Crown Copyright and database right 2018. All rights reserved. Ordnance Survey Licence number 100049190
P01	S3 Issue	RAVI 21/09/20	MPHI 21/09/20	MSHE 21/09/20	--	© Crown Copyright material is reproduced with the permission of Land Registry under delegated authority from the Controller of HMSO. This material was last updated on 2018 and may not be copied, distributed, sold or published without the formal permission of Land Registry. Only an official copy of a title plan or register obtained from the Land Registry may be used for legal or other official purposes.
Rev	Description	Drawn	Checked	Approved	Con App	Scale with caution as distortion can occur.

- Legends/Notes:
- Do not scale from drawing.
 - All dimensions are in millimeters unless otherwise specified.



HS2

Registered in England: Registration No. 06791686
Registered office: 2 Snow Hill, Queensway, Birmingham, B4 6GA

Official

Creator/Originator
Balfour Beatty VINCI

Project/Contract High Speed Rail (London-West Midlands) (Bromford Tunnel) Screening Report			
Zone Bromford Tunnel	Drawn --	Checked --	Approved --
Drawing Title Figure 2.2 (Sheet 2) Proposed Development – Construction Phase	Date --	Scale 1:5000	Size A3
	Drawn/Verifiable Yes (MIDP)	Gate EDD-IDR	Suitability S4
Drawing No. 1MC08-BBV_MSD-EV-DSP-NS02_NL07-170614	Rev. P03.1		

For Continuation Refer to Drawing 1MC08-BBV_MSD-EV-DSP-NS02_NL07-170611

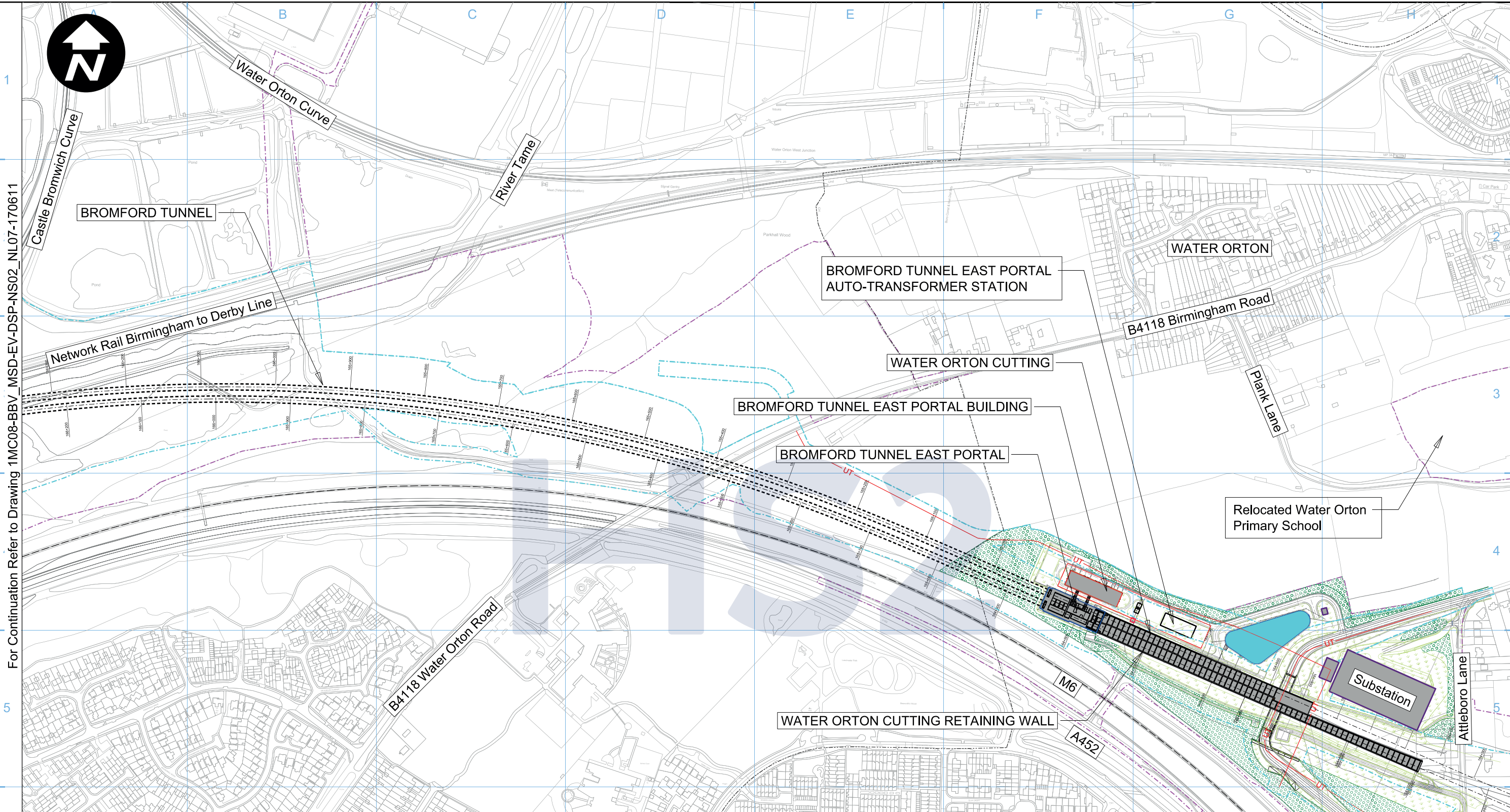

Note: Bridge Profiles indicated at FRL to HS2 track

Depot, station, headhouse or portal building	Landscape mitigation planting (scrub / woodland)	Returned to suitable development use
Tunnel portal	Grassed areas	County boundary
Electricity substation	Borough / District boundary	Main utility works
Balancing pond	Rail alignment formation	Tunnels external extent

--- Rail alignment
--- HS2 Access road
--- Chainage (e.g. 10+000)
--- LLAU - Limits of Land to be Acquired or Used 2017 Act (unchanged)
--- LOD - Limits of Deviation 2017 Act (unchanged)

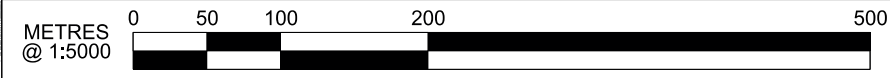
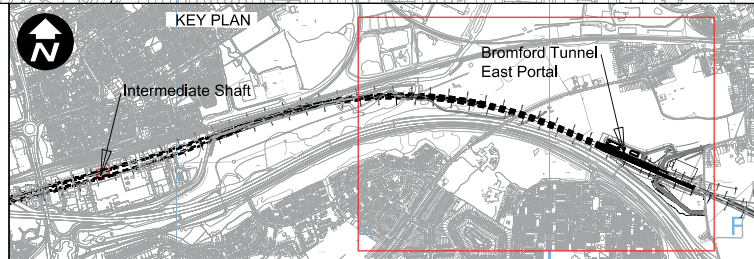

Fit for Stage Acceptance

C01	For HS2 Acceptance	RAVI	MCAR	NMCC	TNOL	HS2 accepts no responsibility for any circumstances which arise from the reproduction of this document after alteration, amendment or abbreviation or if it is issued in part or issued incompletely in any way.
P03	S4 Issue	03/02/21	03/02/21	03/02/21	04/02/21	© Crown Copyright and database right 2018. All rights reserved. Ordnance Survey Licence number 100049190
P02	S4 Issue	RAVI	MCAR	NMCC	---	© Crown Copyright material is reproduced with the permission of Land Registry under delegated authority from the Controller of HMSO.
P01	S3 Issue	02/10/20	02/10/20	02/10/20	---	This material was last updated on 2018 and may not be copied, distributed, sold or published without the formal permission of Land Registry. Only an official copy of a title plan or register obtained from the Land Registry may be used for legal or other official purposes.
Rev	Description	Drawn	Checked	Approved	Con App	Scale with caution as distortion can occur.

This document is issued for the party which commissioned it and for specific purposes connected with the captioned project only. It should not be relied upon by any other party or used for any other purpose. We accept no responsibility for the consequences of this document being relied upon by any other party, or being used for any other purpose, or containing any error or omission which is due to an error or omission in data supplied to us by other parties.

Legends/Notes:

- Do not scale from drawing.
- All dimensions are in millimeters unless otherwise specified.



HS2

Registered in England: Registration No. 06791686
Registered office: 2 Snow Hill, Queensway, Birmingham, B4 6GA

Official

Creator/Originator: Balfour Beatty VINCI

Project/Contract	High Speed Rail (London-West Midlands) (Bromford Tunnel) Screening Report			
Zone	Bromford Tunnel		Drawn	Checked
Drawing Title	Figure 2.3 (Sheet 2) Proposed Development – Operational Phase		RAVI	MCAR
Date	03/02/21	Scale	1:5000	Approved
Deliverable	Yes (MIDP)	Gate	EDD-IDR	NMCC
Drawing No.	1MC08-BBV_MSD-EV-DSP-NS02_NL07-170612	Rev.	S4	C01